

## Remote Microphone Connection Procedures for Cochlear BAHA 6 Sound Processor with Cochlear Mini Mic 2+ as Transmitter

1. Pair the MM2+ to the BAHA.\* If the mini mic has already been paired, skip to Step 3.

\***Pairing** needs to be done at the initial set up only. Once the school MM2+ is paired to the BAHA, pairing holds until another Cochlear accessory (e.g. a home mini mic or TV streamer) is paired to Channel 1 on the BAHA. For this reason, it is recommended home accessories be paired to Channel 2 or 3 on the BAHA.

- a. Turn off the BAHA by opening the battery door.



- b. Turn on the MM2+ by pressing the ON/OFF button until the LED turns green, then release the button.



- c. With the tip of a ballpoint pen, press the pairing button on the back of the MM2+ once. The LED will flash yellow. Within 20 seconds, turn on the BAHA by closing the battery door.



2. Listen for the start-up tune from the BAHA. The MM2+ is now paired.
3. Activate **STREAMING** on the BAHA by pressing and holding the top button for 3 seconds until a melody is heard by the student.

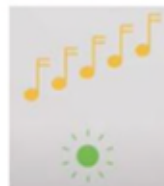

Alternatively, **STREAMING** can be activated with the Remote Control 2 (RC2). Turn **ON** the RC2 by sliding the side switch down. Press the Streaming button on the lower right corner quickly once.



#### 4. Functional Check

- a. Have student wear the BAHA.
- b. From a distance of at least 3 metres, cover your mouth and speak to the student via the mini mic. Ask the student to do follow instructions like “point to the windows” or “touch your nose” and check for understanding.

#### Daily Classroom Routine:

Before instruction begins:

1. Teacher to position the MM2+ approx. 20 cm below the mouth by using either the neck loop or clip.
2. Turn on the MM2+.
3. Student to activate streaming on the BAHA.
4. Teacher to conduct functional check.

During Instruction Breaks (e.g., individual work time, recess)

1. Teacher to mute the mini mic by pressing the Mute button once.
2. LED on MM2+ will flash orange.

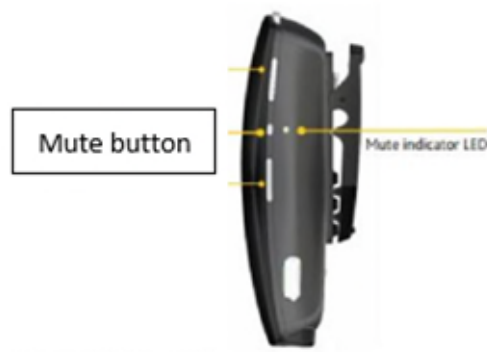

3. When instruction resumes, unmute the transmitter by pressing the Mute button once. The LED will stop blinking.

During small group work (up to 5-6 people around a table):

1. Place the MM2+ on a flat surface at the centre of the group.
2. The omni-directional mics on the MM2+ are automatically activated when placed in a horizontal position.

At the end of the school day:

Turn off the MM2+ and charge it in a safe, dry place.

There is no need to manually toggle OUT of streaming on the BAHA. Streaming automatically stops when the mini mic has been turned OFF or MUTED for five minutes, or when it is out of range (approx. 24 metres).

Auditory Outreach