

Remote Microphone Connection Procedures for the Nucleus 8 – Mini-Mic 2+ as Transmitter

1. Pair the Nucleus 8 to the MM2+. (Pairing is done at initial set up only)
 - a. Turn off the Nucleus 8 by pressing and holding the button for 5 seconds until the indicator light turns a steady orange, then release the button. Alternatively, twist and remove the battery.



- b. Turn on the MM2+ by pressing the ON/OFF button until the LED turns green, then release the button.



- c. With the tip of a ballpoint pen, press the pairing button once. The LED will flash yellow. Within 20 seconds, turn on the N8 by pressing the button on the N8 quickly once OR by attaching the battery. A green light will appear, followed by a blue light, which indicates successful pairing.



2. Activate **STREAMING** on the N8 using either the processor button, the *CR310 Remote Control* or the *Nucleus Smart* app. Look for a blinking blue light on the N8 which indicates successful streaming activation.

2 sec hold on processor button OR *CR310*: 2 second hold on T button OR *Nucleus Smart*: tap "Mini Mic" under "Audio Sources"

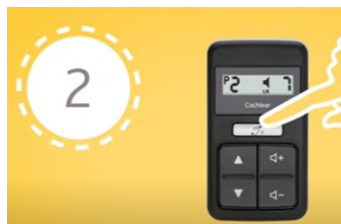

3. Functional check

- a. Have the student put the N8 back on the implant
- b. From a distance of at least 3 metres, cover your lips and speak to the student via the MM2+. Ask the student to do things like “point to the windows” or “touch your nose” and check for understanding.

Daily Classroom Routine

Before instruction begins:

1. Teacher to position the MM2+ about 20 cm below his/her lips by using either the neck loop or clip.
2. Turn on the MM2+.
3. Student to activate streaming on the N8.
4. Teacher to conduct functional check.

During Short Instruction Breaks (e.g. quiet study, individual work time):

1. Teacher to mute the MM2+ by pressing the Mute button once.
2. LED on MM2+ will flash orange.

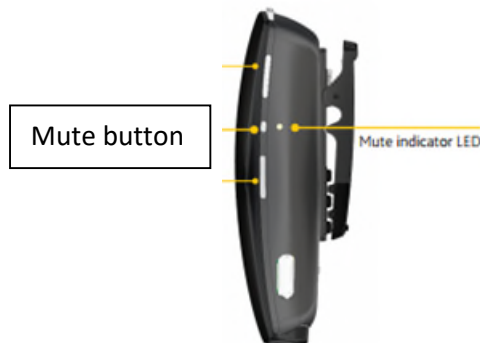

3. When instruction resumes, unmute the MM2+ by pressing the Mute button once. The LED will stop blinking.*

**If it has been 5 minutes since MM2+ was last used, re-activate streaming on N8.*

During small group work (up to 5-6 people around a table):

1. Place the MM2+ on a flat surface at the centre of the group.
2. The omni-directional mics on the MM2+ are automatically activated when placed in a horizontal position.

At the end of the school day:

1. Turn off the MM2+ and charge it in a safe, dry place.
2. Student to toggle out of streaming.