

JANUARY 18, 2024



**Auditory Outreach**  
Provincial Resource Program



# AUDITORY OUTREACH EQUIPMENT FAIR

Presented by **Carrie Siu, M.Sc, Aud(C), RAUD/RHIP**  
*Auditory Outreach Audiologist*

**Lora Baker, B.Ed, M.Sc. R.SLP**  
*Principal & Speech Language Pathologist*

Guest Speakers:

**Lia Best Au.D., RAUD, RHIP, Aud (C)**  
Audiology Field Trainer – Western Canada  
Doctor of Audiology  
Oticon Canada

**Shally Yuan**  
Roger Sales Manager/Audiology Trainer  
Phonak Canada



# AGENDA



Agenda	Speaker
2024 update to AO-PRP equipment library	Carrie
Edumic, Streamer, Programming tips for Oticon hearing aids	Lia
Roger ON, Touchscreen, Focus II	Shally
Mini Mic 2+ and Summary	Carrie

# 2024 EQUIPMENT LIBRARY

## Transmitters

Roger Touchscreen	Roger ON*
Oticon EduMic	Cochlear Mini Mic 2+
Roger Inspiro**	

## Receivers

Roger X	Roger Focus **
Roger Focus II	Roger 20
Roger 21	Oticon Medical Streamer**
Roger MyLink**	MLxi BAHA**

## Accessories

Remote Controls	Monitor Earphones
Lanyards	Touchscreen Screen Protectors
Boom Mic/ Belt Clip (for Touchscreen)	Audioshoes/ DAI Adaptors

We provide **PERSONAL** assistive listening devices that attach to the personal devices (hearing aids, CI/BC processors) of school-aged children (K-12) with educationally significant hearing loss.

List and description of equipment on our website:

[www.auditoryoutreach.ca](http://www.auditoryoutreach.ca)

Under "**equipment loan library**"

\*recommended for middle and high school students

\*\*discontinued and limited availability

# RECEIVER CHOICE GENERAL RULE

- Direct Audio Input (DAI) preferred

- compared to using an intermediary e.g neckloop, direct plug-in of personal receiver, either via an audioshoe or installed receiver, provides the most straightforward way for a student with HL to receive teacher's voice in their ear

- E.g Marvel HA+Roger X (installed) ← Transmitter

- OR Opn Play HA+Roger X (via FM10 audioshoe) ← Transmitter

- OR Nucleus 8 CI + Roger 20 ← Transmitter

- receiver choice dictated by model of HA/CI

# TRANSMITTER CHOICE ...

- when student's HA/CI has no DAI:

- use 1) remote mic/streamer e.g EduMic → Ponto 5

OR 2) connect to RM via an intermediary

e.g Ponto 5 + EduMic (worn around student's neck) + Roger X (plugged into EduMic) + Transmitter

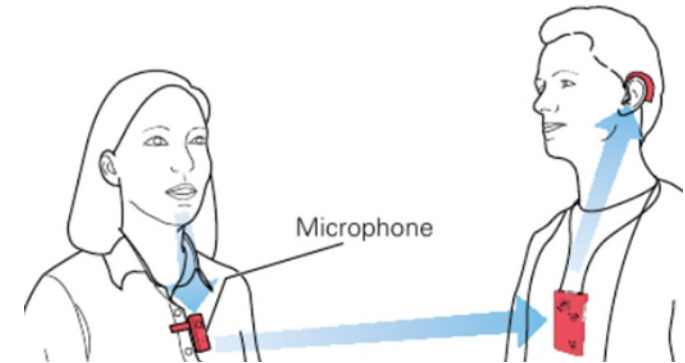

- classroom and teacher considerations

- are there students in same classroom using personal RM?

- is there a sound field speaker in the classroom?

# OVER TO LIA...



# MINI MIC 2+ BY COCHLEAR

- Wireless digital connection using 2.4 GHz frequency
- Can be worn using lanyard and/or clip
- Lightweight (22 g) and small
- compatible CI processors: Nucleus 6/7/8, Kanso, Kanso 2
- Compatible bone conduction processors: Osia 2, BAHA 6/5
- Hearing aids: Resound Enzo/Key
- Euro plug for universal FM receiver
- Line-in for audio input

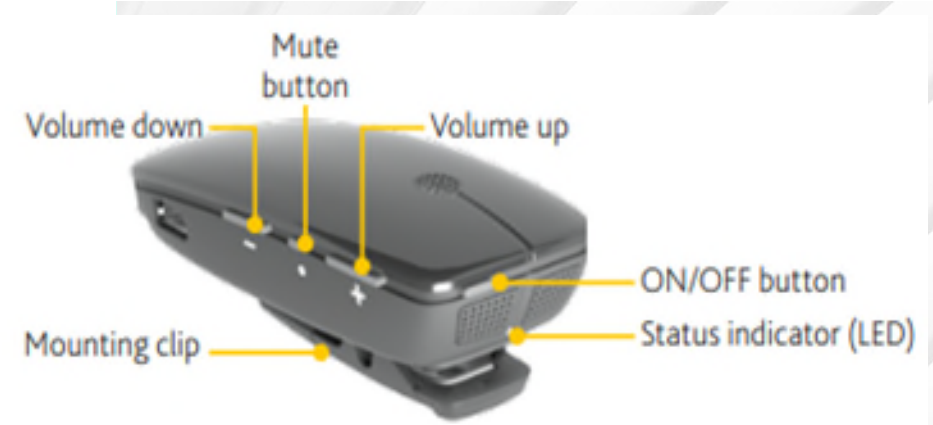

# MM2+ AS TRANSMITTER

- Transmits up to “25 metres” to compatible personal devices
- Requires clear line of sight
- Built-in accelerometer changes microphone reception depending on transmitter position
  - > when worn upright: directional mode for teacher’s voice only
  - > when placed horizontally: omnidirectional for peers’ voices during discussions
- Requires manual *streaming* activation on personal device, at start-up and after break times

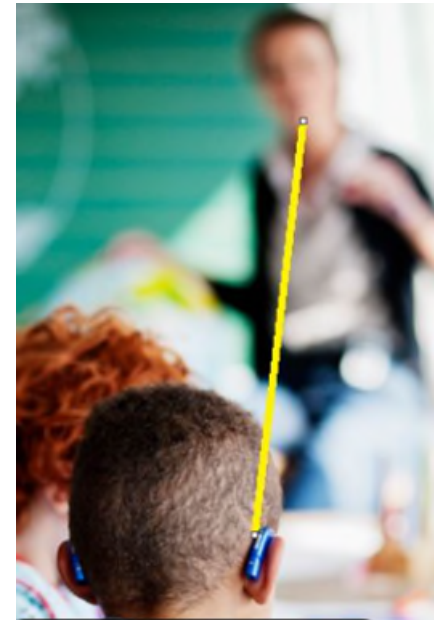



# MM2+ AS INTERMEDIARY

- When worn on the student's neck or placed within ~8 metres (line of sight) of personal device, allows reception of teacher's voice from another RM transmitter
- RM receiver (e.g. Roger X) plugs into the MM2+
- Allows students to benefit from features that are not on the MM2+  
e.g. team-teaching and compatibility with sound field
- when teacher needs to wear a Roger transmitter for another student OR for a sound field system

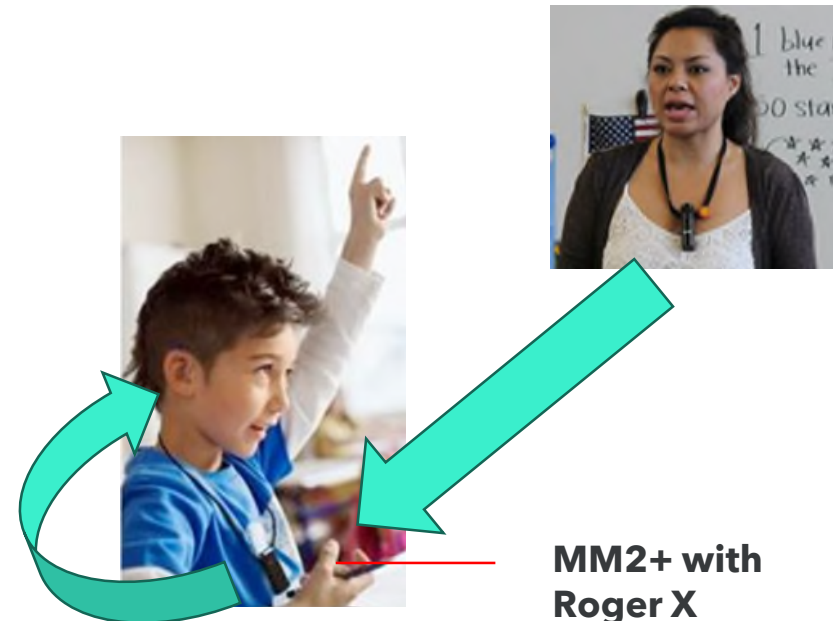

# THANK YOU!!

Auditory Outreach contacts:

[Carrie.Siu@sd47.bc.ca](mailto:Carrie.Siu@sd47.bc.ca)

[Lora.Baker@sd47.bc.ca](mailto:Lora.Baker@sd47.bc.ca)

Website:

[www.auditoryoutreach.ca](http://www.auditoryoutreach.ca)



# Roger Solutions

Equipment Fair Webinar

Shally Yuan M.Sc.Aud(C), Audiology Trainer and Roger Sales Manager

A Sonova brand

**PHONAK**  
life is on

# Agenda

1. Roger ON V2
2. Touchscreen
3. Focus
4. Programming Tips

Honourable mention: Inspiro & MyLink



Roger ON V2

# Roger ON V2

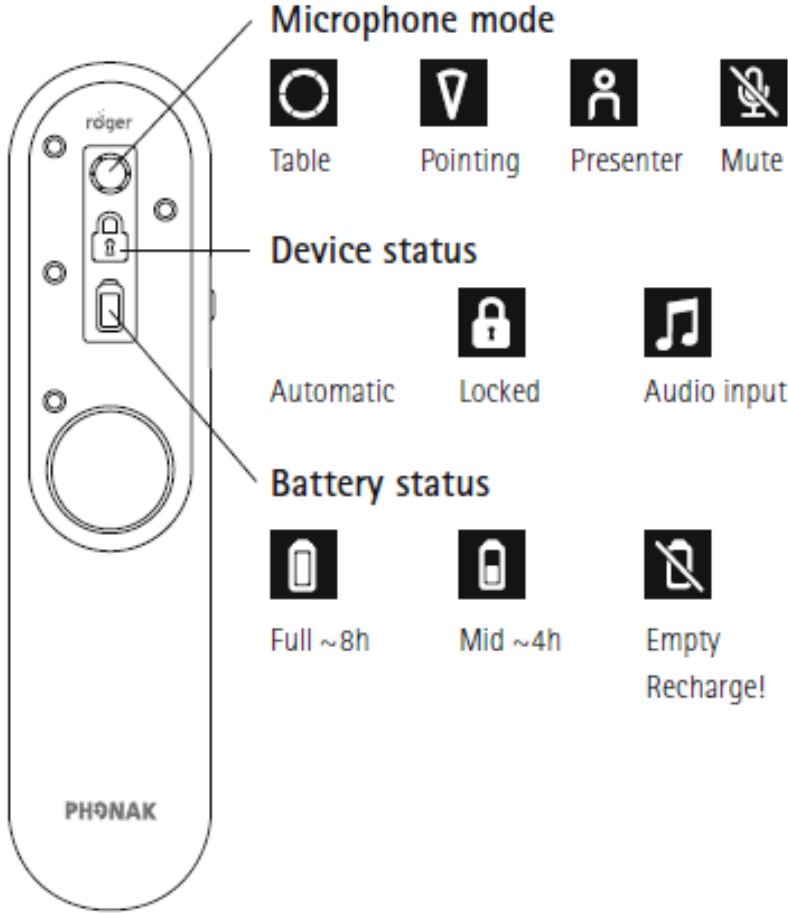

**Range: 25m**

**3 hours to charge, 8 hours of usage**

# Automatic switching to the situation:



**Table mode**  
with MultiBeam 2.0 Technology



**Pointing mode 2.0**  
with three built-in microphones



**Presenter mode**  
with orientation independent  
presenter mode

# Pairing

- Hold within 4 inches of hearing device

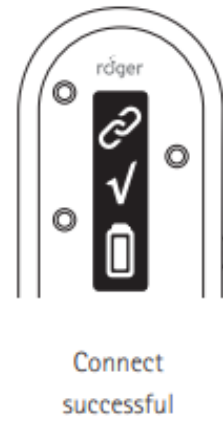
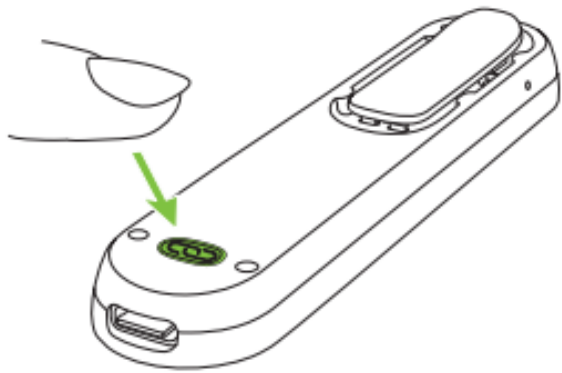



# Roger On V2 can be used like a headset for online calls.



## NEW Headset mode

- Just Plug in!
- Roger On V2 has two-way voice streaming.
- It can connect to a computer to be used like a headset.
- Includes noise reduction and directionality.

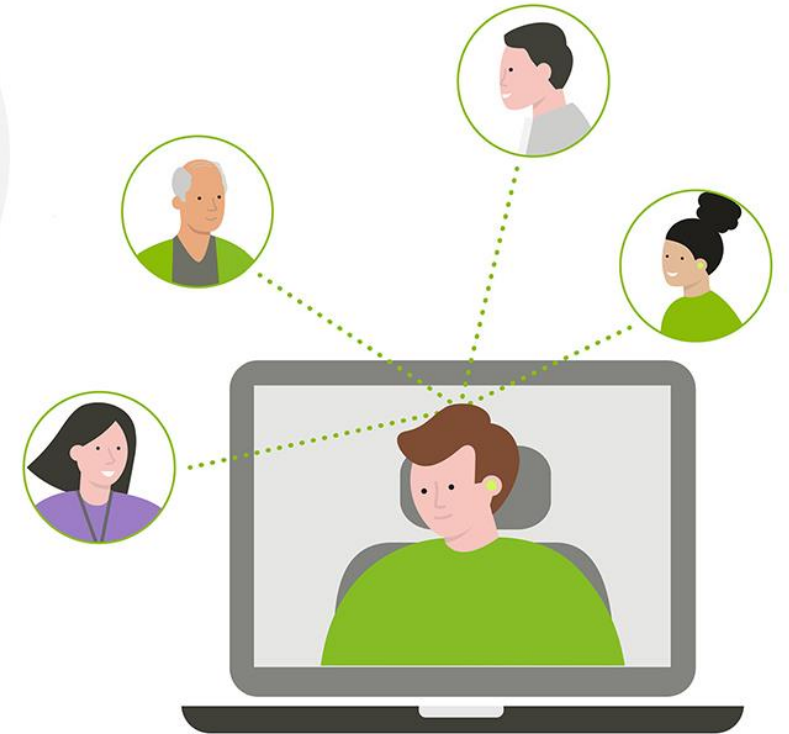

# How to use Headset Mode

1. Plug the smaller end (USB C) of the charging cable into your Roger On.
2. Plug the larger end (USB A) of the cable into the USB port on your computer and switch your computer on.
3. Start the online call on your computer.
4. Now you can hear the online participant(s) in your ears and you can talk into your Roger microphone.

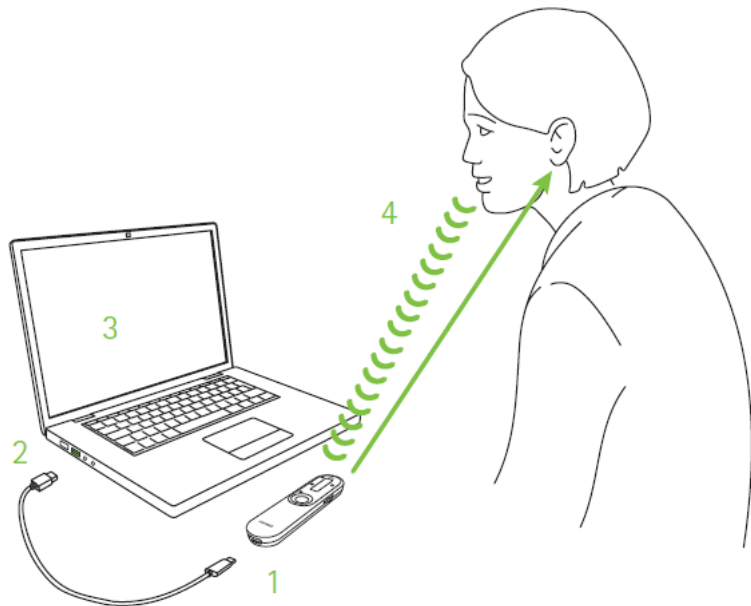

During the call, you can either place your Roger On on the table, point it in your direction or wear it on your chest. For best sound quality, we recommend to wear Roger On on your chest.

Roger On shows a headset icon to indicate that it is used in an online call:

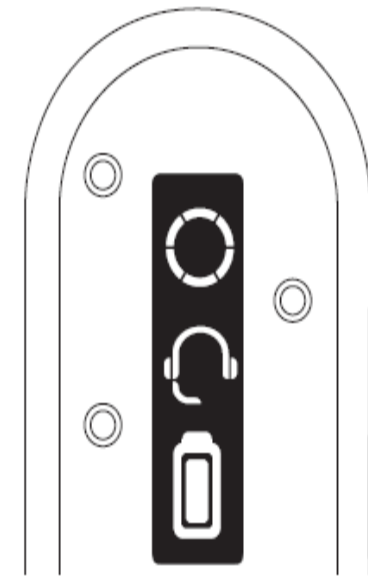

# App to personalize

With **myRogerMic app** you can:

- Change microphone mode
- Steer microphone beam
- Mute and unmute
- See microphone status
- Save custom modes

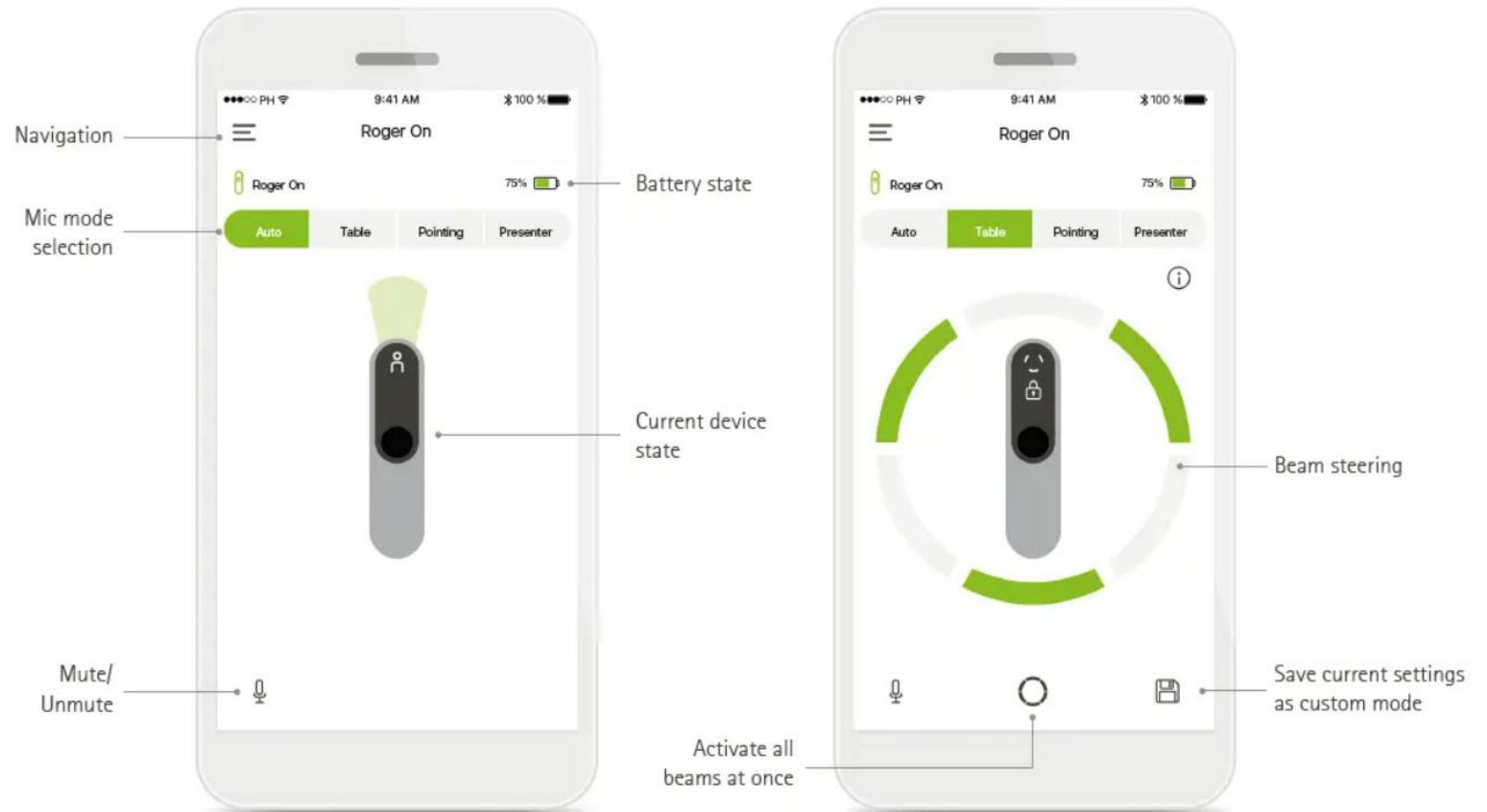

# Takeaways

## Benefits

- Smaller, more compact
- Lightweight – easier for teachers to wear
- Can be muted without flashing red light
- Has all the functions of the Touchscreen: Table, Pointing, Presenter
- BONUS: Has headset mode
- Has app that students can download for greater control

## Keep in Mind

- Not compatible with Soundfield/Digimaster, Passaround Mics, Multimedia Hub
- May be easier to lose
- More appropriate for middle/high school students

# Roger Touchscreen

# What is it?

- Wireless microphone to allow improved listening of Teacher's voice over noise and distance
- Microphones can be networked for co-teaching
- Compatible with other Roger accessories (e.g. Digimaster, Passaround, Multimedia Hub)
- Adaptive gain



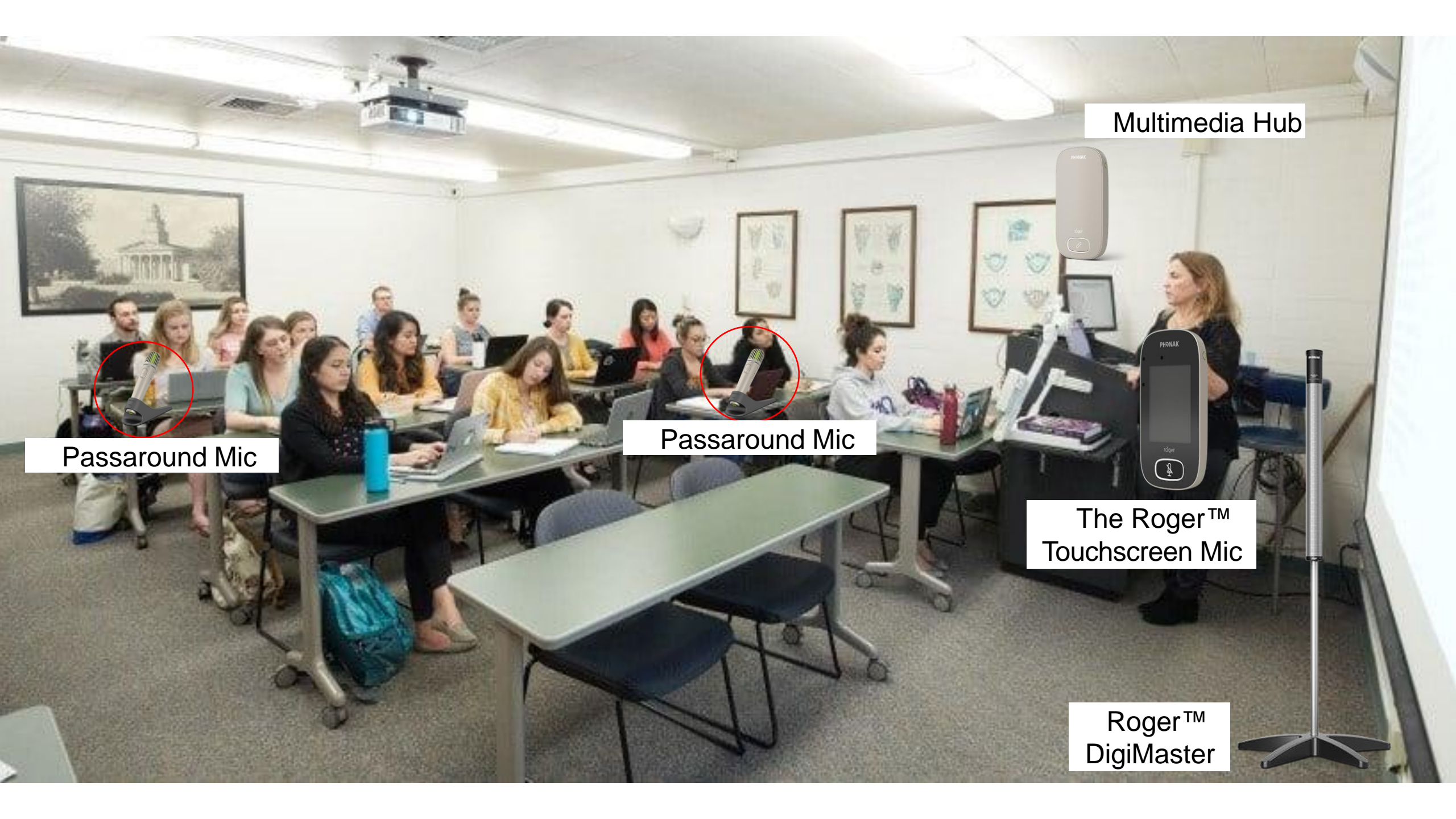

Multimedia Hub



Passaround Mic



Passaround Mic



The Roger™  
Touchscreen Mic

Roger™  
DigiMaster



# Adaptive gain

Gain adaptively adjusts, allowing the teacher's voice to be heard over classroom noise.

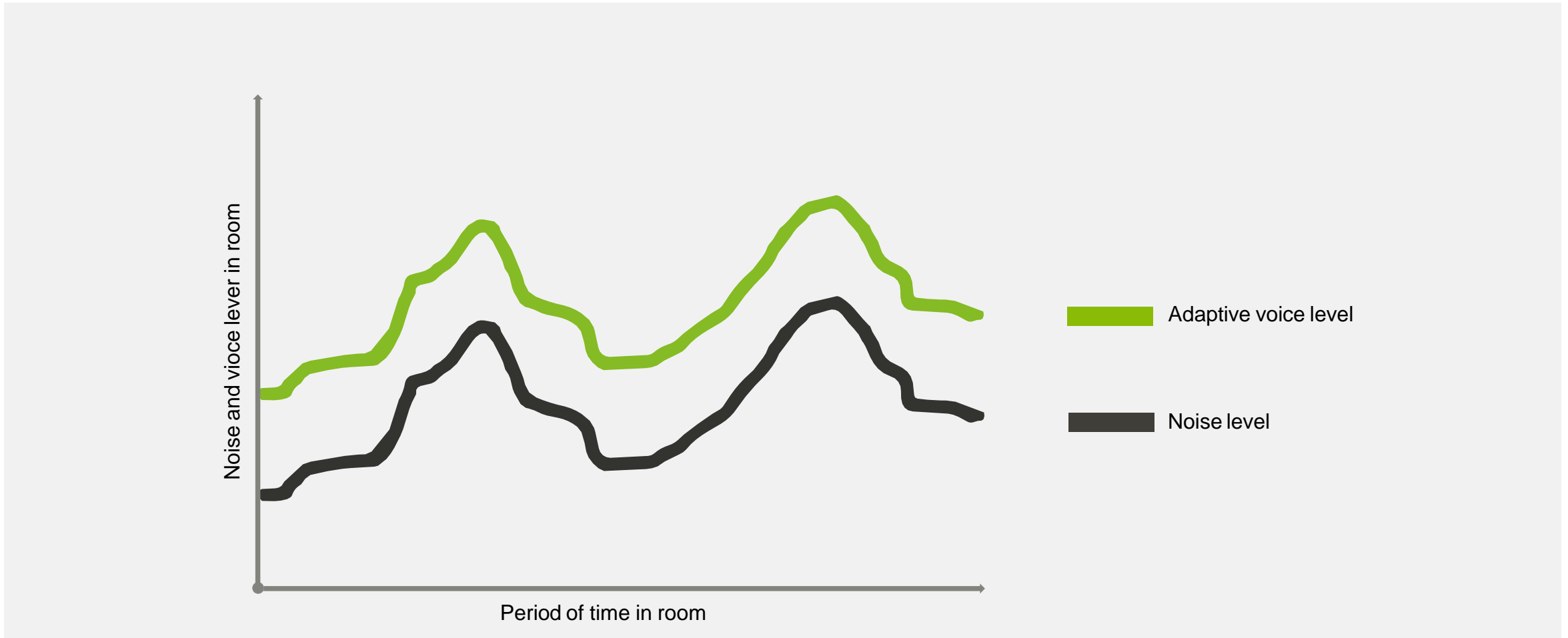



# Roger Focus II

# What is it?

Receives signal from Roger microphones to reduce the effect of speech in noise and over distance

Use cases:

- Unilateral hearing loss
- Auditory Processing Disorder
- Autism Spectrum Disorder

Compatible with all Roger Microphones (Touchscreen, Roger ON, etc)

**NOT a hearing aid – provides no amplification**

**roger**



# Connecting with Touchscreen



- Hold Roger Focus one at a time **close** to the Touchscreen
  - Maximum 4 inches away
- Tap “Connect” on the Touchscreen

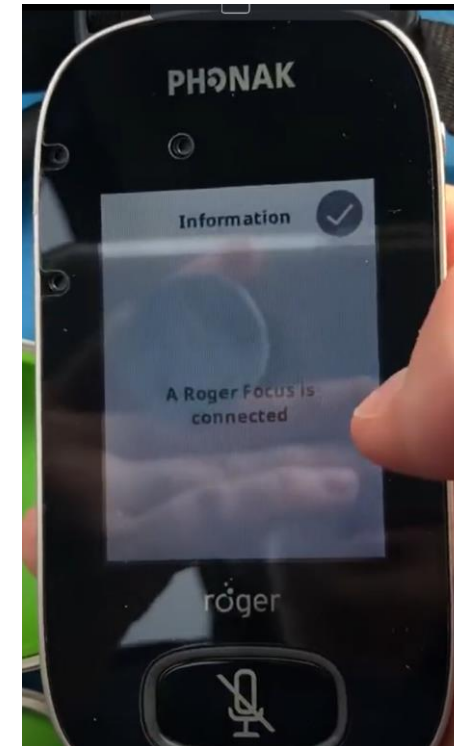

# Programming tips

# Two different receivers!

## 1. Roger X(02) “Educational”

- Compatible with the entire portfolio of Roger products (including Touchscreen, Digimaster, Multimedia Hub, Passaround Mic)
- Available at PRP

## 2. Roger X(03) “Personal”

- Typically purchased by family for after school or summer use
- Only compatible with: Roger ON, Roger Select, Roger Table Mic, Roger Clip On Mic
- More cost effective for family



Navigation: Feedback & real ear test | AudiogramDirect | Global tuning | **Fine tuning** | DataLogging | Device options

---

Program manager >>

ALL PROGRAMS

▼ AUTOMATIC PROGRAMS 9

- AutoSense OS 5.0
- Calm situation
- Speech in noise
- Speech in loud noise
- Speech in car
- Comfort in noise
- Comfort in echo
- Music

🔗 AutoSense OS 5.0 (streaming)

- Media speech + mic
- Media music + mic

▼ STREAMING PROGRAMS 3

- 🎧 PartnerMic + mic
- 📞 Phone call + mic
- 📶 RogerDirect + mic

ADDITIONAL PROGRAMS +

**Program activation**

Automatic  
 Manual  
 Manual (with beep)

---

**Adaptive microphone behavior**

Standard  
 Dual

---

**Hearing aid microphone**

Enable microphone 0 dB 0 dB

12  
 Fixed directional

**SoundRelax**  8 Weak

**NoiseBlock**  8 Weak

**Soft noise reduction**  0 Off

**WindBlock**  13 Moderate

---

**WhistleBlock**  0 Off

Gain & MPO
Program options
Audibility fine tuning
SoundRecover2
Automatic fine tuning

Notifications

Adaptive microphone behavior

- Standard
- Dual

**STANDARD**

If the noise level rises, the Roger signal will increase up to 20 dB.  
The hearing aid microphone will remain stable.

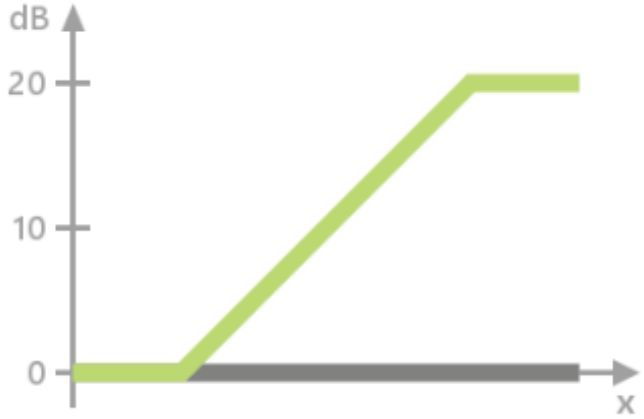

x = Input noise    — Roger

**DUAL**

If the noise level rises, the Roger signal will increase up to 10 dB.  
If the noise level rises even more, the hearing aid microphone will be attenuated to -10 dB.



— Hearing aid microphone

# Roger Inspiro and MyLink (Limited Availability)



# What is it?



- **Roger Inspiro** (Replaced by Roger Touchscreen)

- **Roger MyLink** (Replaced by Roger Neckloop)

## Use cases:

- Roger Inspiro compatibility with old Roger Soundfield/Digimaster
- Child with non-Phonak HAs to access Touchscreen signal with MyLink (\*\*HA must have telecoil)
- Speech to text with Roger MyLink

Thank you for listening!

Questions: [shally.yuan@phonak.com](mailto:shally.yuan@phonak.com)

24 January 2024

# Oticon Technology in the Classroom

Lia Best AuD RAUD RHIP  
Audiology Field Trainer for Western Canada



# EduMic – A remote microphone system

Breaking barriers inside and outside the classroom

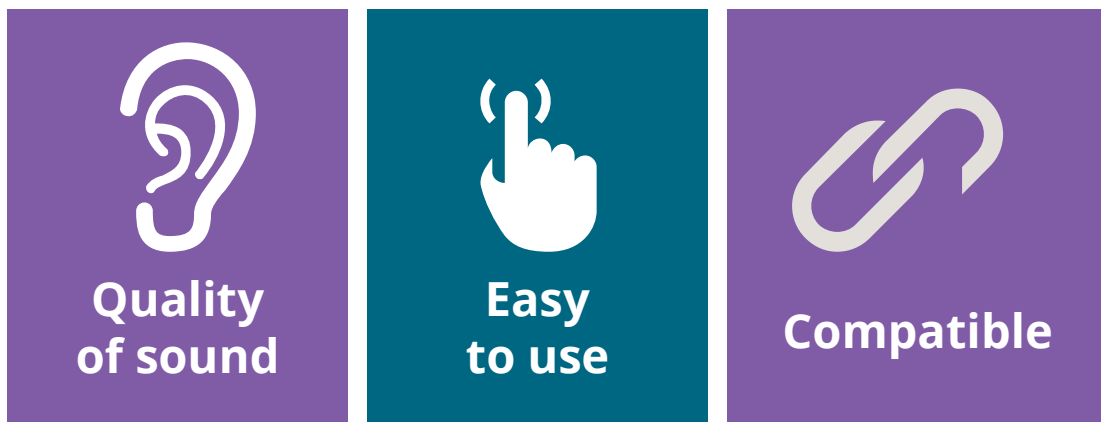

This is NOT just a basic Bluetooth mic



## Why EduMic?

- When noise, distance and reverberation become challenging, EduMic is a vital partner to hearing aids.
- EduMic uses the same innovative technology found in Oticon hearing aids to analyze, balance and remove noise.
- It delivers stable and clear access to a speaker's voice by continuously monitoring the environment and removing unwanted noise - even between words.
- EduMic also includes Wind Noise Management, allowing for use outside - without a reduction in sound quality.
- EduMic is tailored to the user's needs of discreetness and comfort, and does not require any external receivers



# The EduMic has 4 Modes



**Microphone mode**  
(20 m range)



**Jack mode**  
(20 m range)



**FM mode**  
(3 m range)



**Telecoil mode**  
(3 m range)



# The EduMic package

What's in the box?



EduMic



Adjustable lanyard



3.5 mm jack cable



Instructions for use



Wall charger



USB charger cable

# EduMic Overview

Connections, charging and rotating clip



## 3.5 mm jack input

Connection to external audio sources

## FM connector

For universal receivers

 2.4 GHz	
<b>Battery Life</b>	10 Hrs
<b>Recharging Time</b>	2.5 Hrs
<b>Battery Type</b>	Lithium-ion



## Micro USB port

For charging

## Rotating clip

Attaches to lanyard or clothes



# Easy to use

## Buttons & microphones

**Push button**  
ON, OFF, mute,  
telecoil, clear  
pairings

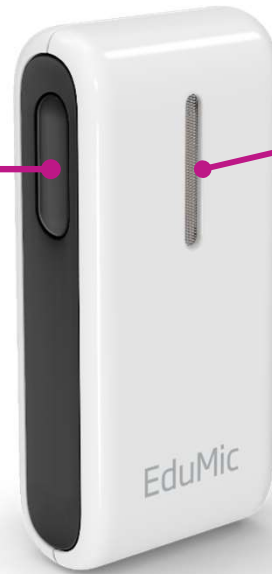

**Microphones**  
Sound in

# Turning On/Off and Muting

Turn on/off

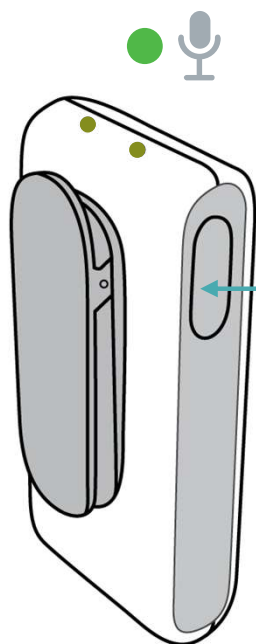

Press for  
2 seconds

Mute/unmute

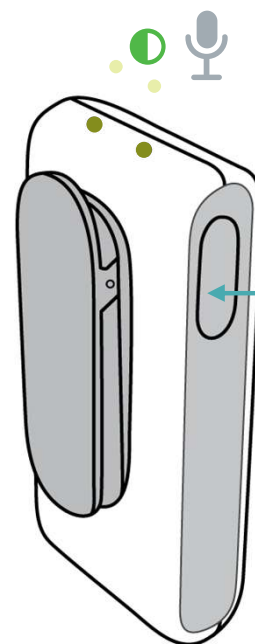

Brief press

# Adjust the EduMic with the NEW Oticon Companion App

Adjust Streaming and Hearing Aid Microphone Separately

Mute EduMic Directly from App

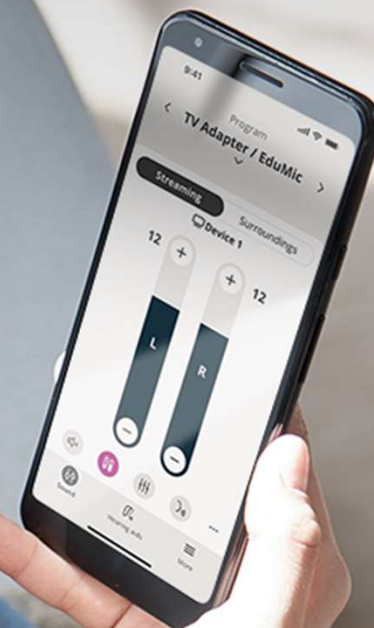

Apple, the Apple logo, iPhone, iPad, and iPod touch are trademarks of Apple Inc., registered in the U.S. and other countries. App Store is a service mark of Apple Inc. Android, Google Play, and the Google Play logo are trademarks of Google LLC.

oticon



## Muting on the Companion App



**Step 1**  
Open the Companion app



**Step 2**  
Select the TV Adapter/  
EduMic program



**Step 3**  
Select the  
Streaming tab

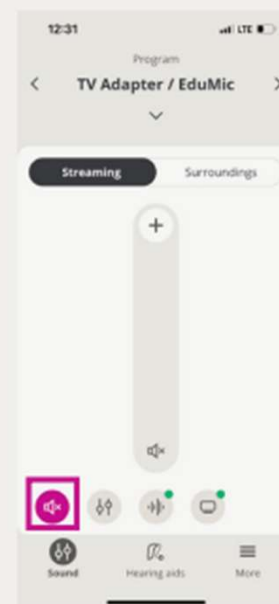

**Step 4**  
Select the mute icon  
to mute the EduMic

# EduMic Overview

## Status indicators



Power indicator



LED

Status indicator



### Power indicator

Charging time for full charging is 2.5 hours. A quick 30 minute charge during a break provides approx. 2.5 hours of use. When the power indicator flashes RED, there is approx. 2 hours of battery life remaining.

○ White	Start-up
● Green	Fully charged
● Flashing yellow	Charging
● Flashing red	Battery low



### Status indicator

A steady light indicates you are sending sound. A flashing light indicates that EduMic is muted.

○ White	Start-up
● Flashing blue	Pairing in progress
● Green	ON/microphone mode
● Flashing green	Mute in microphone mode
● Yellow	Jack/FM mode
● Flashing yellow	Mute in jack/FM mode
● Red	Pairings cleared
● Magenta	Telecoil mode
● Flashing magenta	Mute in telecoil mode

# How to Wear EduMic

## Correct Placement

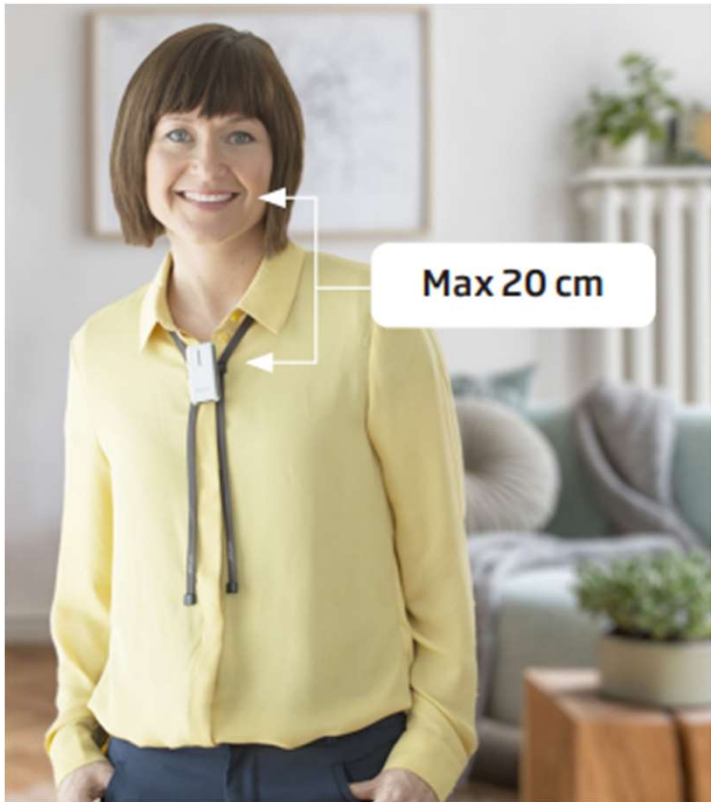

Microphone placement is away from body

## Incorrect Placement



oticon



# Pairing to Hearing Aids

- EduMic can be paired to the below Oticon Hearing Aids:
  - OPN Play
  - Xceed Play
  - Play PX
  - Real
  - More
  - OPN S
  - PONTO 4 and 5 (Bone Anchored Device)
- Pairing is usually done by the Audiologist but can easily be paired out of the clinic by parents and educators



# How to Pair EduMic to Oticon Hearing Aids

## • Step 1

- Ensure EduMic is turned ON
- Turn Hearing Aids OFF and ON

## • Step 2

- Place Hearing Aids close to Edumic
- The status indicator on the Edumic will flash blue while pairing and then turn solid green
- EduMic is now ready for use with the hearing aids





# 3 RMS Configurations for the Classroom

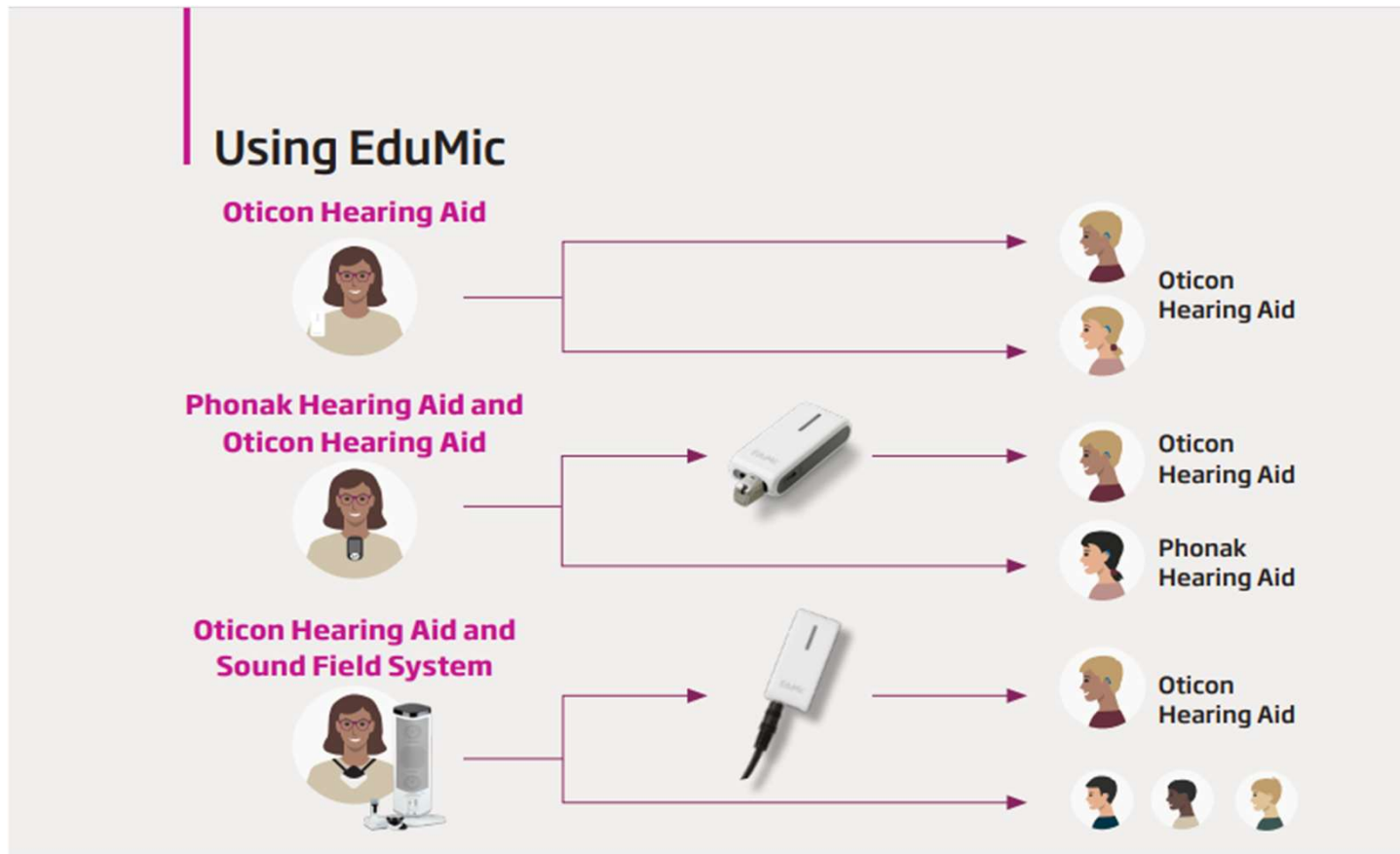

# Top 5 Benefit of EduMic

- 1. Improved Speech Understanding** in Noise, Reverberant Spaces, and Across Distances
- 2. OpenSound Navigator** continuously monitors the environment and removes unwanted noise – even between words.
- 3. EduMic** delivers stable and clear access to the speaker's voice with the push of 1 button.
- 4. User friendly, built to last, and no additional receivers required.**
- 5. Great for use inside and outside of the classroom:** on the playground, during fieldtrips or extracurricular activities, for online learning or at home, around the dinner table, in the car, or at other social gatherings.

# Support at your finger tips



oticon Technology in the Classroom



# EduMic Verification



Clinicians can access the EduMic Verification Guide from Oticon's ESHOP or by contacting me for a copy

Oticon Technology in the Classroom



# Adjusting EduMic in Genie Software

The screenshot displays the Oticon Genie software interface during the 'END FITTING' stage. The top navigation bar includes icons for CLIENT, WELCOME, SELECTION, FITTING, and END FITTING (which is highlighted with a checkmark). The user is identified as 'Play PX 1 OpenBass dome' with a device ID of '85'. The left sidebar contains a menu with options: 'END FITTING', 'Save and Exit', 'Buttons and Indicators', 'Batteries', 'Accessories', 'Generate Report', 'MORE TOOLS', and 'LINKS'. Below the menu are icons for 'RemoteCare' and 'SoundStudio', along with a 'Reference sound der' control. The main workspace is divided into four sections: 'PHONE', 'TV ADAPTER / EDUMIC', 'CONNECTCLIP', and 'REMOTE CONTROL'. The 'TV ADAPTER / EDUMIC' section is active, showing two identical adjustment panels. Each panel features three sliders: 'TV Adapter / EduMic Loudness' (with 'Softer' and 'Louder' indicators), 'M relative to TV Adapter / EduMic' (with 'Softer' and 'Louder' indicators), and 'Sound quality' (with 'Fuller' and 'Brighter' indicators). Below the sliders is a 'Power Bass' control set to 'High'. A status message at the bottom of the workspace reads 'No TV Adapters / EduMics paired'.

# Oticon Medical Streamer

Ponto 3 and non-bluetooth hearing aids (models that predate the OPN)

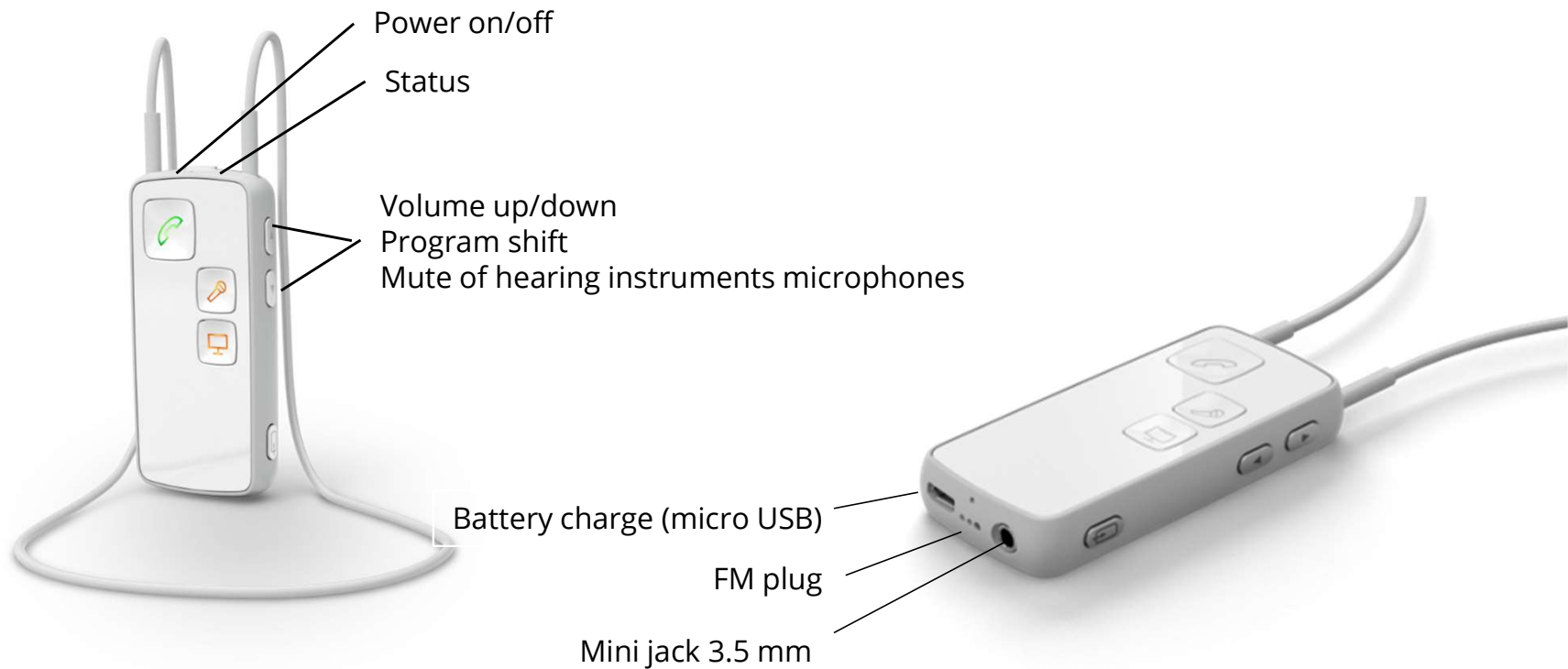

Share this page in [f](#) [t](#)



# Partnership in Hearing

Welcome to our NEW resource hub where you can learn about the latest developments in paediatric hearing healthcare.



Events



Resources



Podcast



Scan this QR code for access to PIH page



oticon Technology in the Classroom

